

Topi-Click® Dispensing Instructions



1. Open

Pop off the cap of the Topi-CLICK® container by placing your thumb under the tab on the protective outer cap and pressing upward.



2. Prime

Your Topi-CLICK® may need to be primed. Rotate the base until the cream easily dispenses onto the applicator pad.

Note: pressure may have formed in transit, which may cause the cream to dispense rapidly upon initial rotations. Your Topi-CLICK® comes overfilled to account for waste caused by priming.

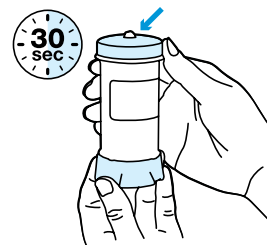

3. Turn

Turn the base to dispense the number of clicks specified in the instructions on your prescription label. Let the container sit for 15–30 seconds to allow all the cream to collect on the applicator pad.

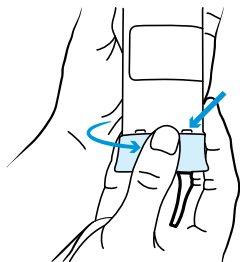

4. Align

Watch the visual indicators when rotating the base. Be sure to leave the base in the registered CLICK position by aligning the base column with the tube node after each use.

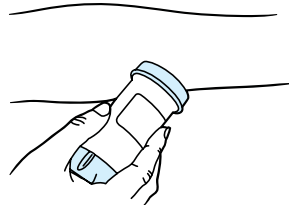

5. Apply

Apply the medication by rubbing the cream from the applicator pad to the area of skin as directed by your healthcare provider.

Note: it may take up to a minute to completely absorb the cream into your skin.

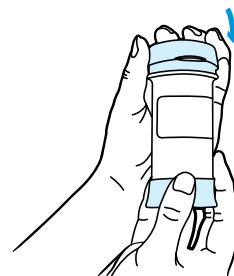

6. Close

Replace the cap after each dose to prevent evaporation. Be sure the cap snaps on tightly.

7. Refill

The bottom of the plunger is the indicator line; when it reaches the embossed line below the word “REFILL” approximately 32 clicks are left. Approximately 12 clicks remain at the line above the word “REFILL”.



Dosing Guide

1 Click	0.25 mL
2 Click	0.50 mL
3 Click	0.75 mL
4 Click	1.00 mL